

BauLinkBeam

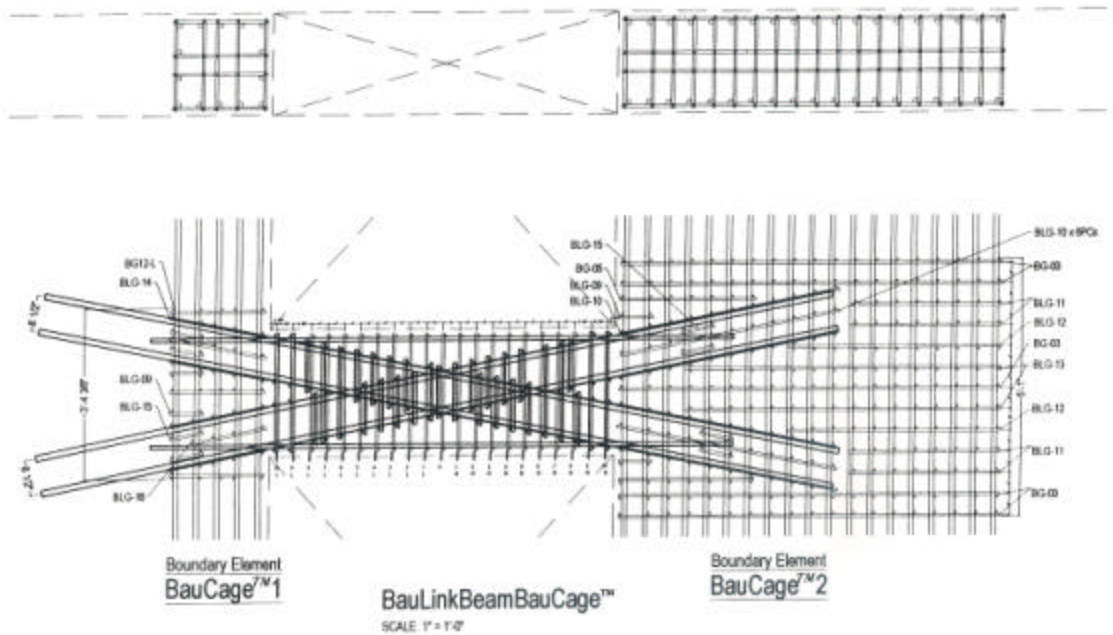

The BauGrids for the BauLinkBeam can be either shipped to the site directly or to the yard.

GridCages can be assembled in either place or supplied by BauTech.

Two types of GridCages are supplied. The Boundary Element GridCage (BEG/C) are located each end of the LinkBeam Grid Cage (LBG/C). The BEG/C has sloping horizontal BauGrids while the LBG/C has only vertical BauGrids.

In most cases, two-story high BauCages composed of two LBG/C with BEG/C each edge will have horizontal and diagonal beam bars charged at grade and then the double "H" BauCage is craned into place and connected using SpliceGrids and Locking Bars.

Where onsite space restrictions prohibit at grade beam rebar installation the separate GridCages will be positioned first and then the rebar will be charged into the erected GridCages.