

BauBridge

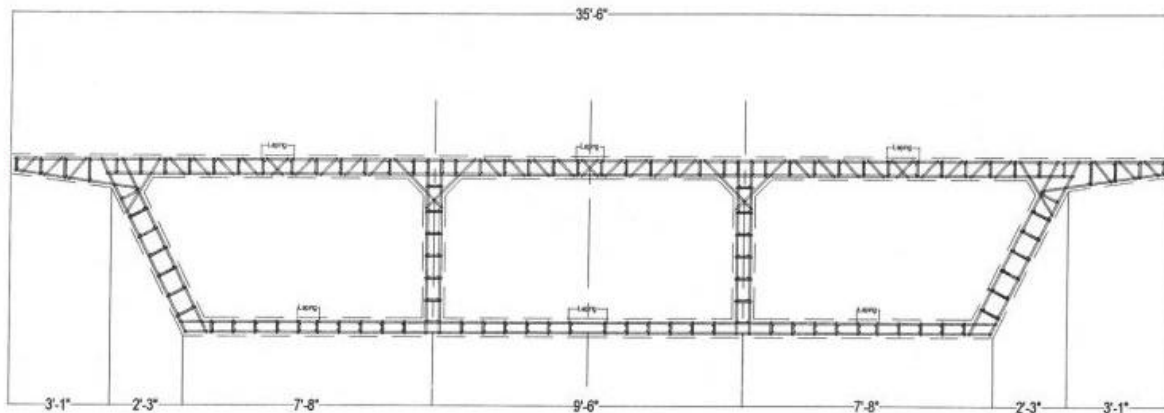

Self-supporting PreFormed and PreClad BauCages use a minimum amount of shoring to reduce traffic disruption. PreClad BauCages with plant installed BauFishlines will speed installation of Post-Tension tendons. Mild steel lap splice bars will also be riding loose in the PreFormed and PreClad BauCages, so that once the cages are in position, the lap bars can be quickly moved into their final position.

BauShipFlat BauCages and GridCages can be shipped to precast yards in an efficient compact manner. At the precast yard, the BauShipFlat BauCages with BauFishlines pre-installed can be quickly expanded and set into the casting forms. The pre-stress tendons can then be connected to the BauFishLine and quickly pulled along the full length of the casting bed, inside the BauCages.

The BauBridge process offers segmental bridge contractors a very dimensionally precise product to speed their casting of segments.

Using BauGridders and BauCagers, very dimensionally exact BauGridCages and BauCages can be quickly manufactured and assembled at the segment casting yards. This semi-automatic process will also include the exact positioning of the tendon ducts within the dimensionally exact BauCages. Very Large but still very exact BauCages can then be lowered into the segment form.

Using BauTech's relocatable BauGridder and BauCager process, the entire manufacturing and assembly process can be done adjacent the segmental casting operation.